

AIR CONDITIONER

TEMPSTAR[®]
Heating and Cooling Products

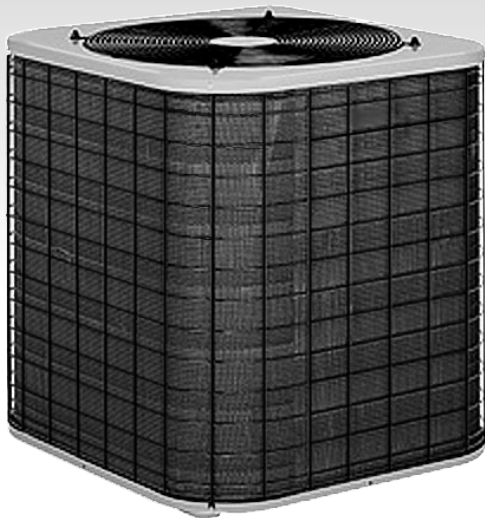

Representative photo only, some models may vary in appearance.

1 1/2 THRU 5 TONS SPLIT SYSTEM 11 - 13 SEER

FEATURES

- Scroll Compressor
- Sweat valve refrigerant connections
- Copper tube / Pre-painted aluminum fin coil
- Fan motor in-line disconnect plug
- Factory charged with R-22
- Top air discharge
- Galvanized steel with integral base rail
- Triple step paint process
- Coated inlet air grille
- 10 Year limited compressor warranty



Rated in accordance with ARI Standard 210. Certification applies only when used with proper components as listed with ARI.

421 21 9001 05

UNIT SPECIFICATIONS

Model Number		CA9018VKD	CA9024VKD	CA9030VKD	CA9036VKD	CA9042VKD	CA9048VKD	CA9060VKD
Electrical Data	Voltage-Phase-Hz	208 / 230-1-60						
	Voltage Range (Min-Max)	197 - 253						
	Minimum Circuit Ampacity	12.6	14.1	18.1	21.9	23.8	31.0	37.4
	Wire Size / Max. Length (AWG Cu) (Ft.) U.S. Only	# 14 / 49	# 14 / 36	# 12 / 45	# 10 / 58	# 10 / 50	# 8 / 64	# 8 / 50
	Time Delay Fuse (Amps)	15	20	25	30	30	40	45
	Max. Fuse or HACR Type Breaker Size (Amps)	20	20	30	35	40	50	60
Compressor Data	Voltage-Phase-Hz	208 / 230-1-60						
	Full Running / Lock Rotor Amps	9.0 / 42	10.3 / 56.0	13.5 / 72.5	16.0 / 88.0	20.0 / 104.0	26.4 / 129.0	32.1 / 169.0
Fan Data	Voltage-Phase-Hz	208 / 230-1-60						
	Horsepower / Type	1/5 / PSC	1/5 / PSC	1/5 / PSC	1/3 / PSC	1/4 / PSC	1/4 / PSC	1/4 / PSC
	Full Load / Lock Rotor Amps.	1.3 / 2.3	1.3 / 2.3	1.3 / 2.3	1.9 / 3.8	1.4 / 3.2	1.4 / 3.2	1.4 / 3.2
	Speeds / RPM (Max)	1 / 1075	1 / 1075	1 / 1075	1 / 1075	1 / 840	1 / 840	1 / 840
Outdoor Coil Data	Total Face Area Sq. Ft. (m ²)	10.7 (1.24)	10.7 (1.0)	11.6 (1.08)	21.3 (1.97)	20.02 (1.86)	24.0 (2.2)	26.7 (2.48)
	Fins Per Inch / Rows	20 / 1	20 / 1	20 / 1	22 / 1	22 / 1	22 / 1	22 / 1
	Tube Diameter (OD) (In.)	3/8						
Refrigerant Connection And Charge	Suction (Fittings Size)	3/4				7/8		
	Liquid (Fittings Size)	5/16				3/8		
Weights	Factory Charge R-22 (Oz)	75	80	91	124	128	164	191
	Shipping / Net Pounds Lbs.	130 (119)	132 (121)	134 (123)	188 (175)	195 (185)	237 (227)	258 (248)

MODEL NUMBER IDENTIFICATION GUIDE

MODEL NUMBER	C	A	90	24	V	K	D	SALES CODE
PRODUCT FAMILY	C = Condenser B = Blower						ELECTRICAL CODE VOLTS PHASE CYCLE K 208/230 1 60	
PRODUCT TYPE	A = Air Conditioning H = Heat Pump C = Cabinet						CONNECTIONS S = Sweat V = Sweat/Valve X = Other	
SERIES	90 = 9000 Series						CAPACITY MBTUH 24 = 24,000	

ACCESSORIES

Model / Part Number	Description	Use With
24370800 **	Compressor Anti-short cycle 24 Volt 3 Min. Time Delay	All Models
1070822 **	Compressor Anti-short cycle 24 Volt 5 Min. Time Delay	All Models
1053477 **	Compressor Crankcase Heater Solid State "Stick On" Type	All Models
1148113 **	Compressor Crankcase Heater "Wrap-around" Type	All Models
1081848 **	Compressor Sound Jacket	1 1/2 Ton
1060833 **	Compressor Sound Jacket	2 Thru 3 1/2 Ton
1060834 **	Compressor Sound Jacket	4 and 5 Ton
AMF153TKA	TXV153 Expansion Valve Kit	1 1/2 to 3 Ton New Coils
AMF355TKA	TXV355 Expansion Valve Kit	3 1/2 to 5 Ton New Coils
1148671 **	Fan Cycling Switch (Low Ambient Control)	All models

** Order from service parts

PERFORMANCE DATA COOLING

Outdoor Model	Indoor Model	BTUH	Base Match SEER	ACCESSORIES			EER	WATTS	S/T	CFM	Orifice	BELS
				+ TD1	+ TXV	+ TD1 + TXV						
				SEER	SEER	SEER						
CA9018VKD	EP*18B15A	17,900	10.90	11.25	11.50	-	10.6	1689	.73	600	.051#	70
	EP*24B15A	19,100	11.20	11.50	12.05	-	11.1	1720	.72	600	.051#	
	EP*30(B15,F19)A	19,300	11.30	11.60	12.05	-	11.3	1708	.72	600	.051#	
	EP*30F19A & EV12F1900A	19,100	-	-	13.05	-	12.3	1553	.73	600	TXV	
	EX*24B15A	19,900	12.50	-	-	-	11.6	1716	.72	600	TXV	
	EX*24(B15,F19)A	19,900	12.50	-	-	-	11.6	1716	.72	600	TXV	
	EX*24F19A & EV12F1900A	19,900	13.50	-	-	-	12.9	1543	.73	600	TXV	
	EAH5524SA	20,000	-	12.00	-	-	11.3	1770	.74	600	.051#	
	FCX2400A	19,000	12.50	-	-	-	11.4	1666	.72	600	TXV	
CA9024VKD	EP*24B15A	22,400	11.30	11.50	11.60	-	10.4	2154	.75	800	.059	72
	EP*30(B15,F19)A	22,600	11.20	11.40	11.60	-	10.3	2194	.75	800	.059#	
	EP*30F19A & EV12F1900A	22,800	-	-	13.05	-	11.6	1966	.76	800	TXV	
	EP*30(B15,F19)A	22,600	11.20	11.40	11.60	-	10.3	2194	.75	800	.059#	
	EP*36(B15,F19,J22)A	23,600	11.50	11.70	12.00	-	10.7	2206	.76	800	.059#	
	EP*36F19A & EV12F1900A	24,000	-	-	13.05	-	11.9	2017	.77	800	TXV	
	EP*36J22A & EV16J2200A	24,000	-	-	13.05	-	11.9	2017	.77	800	TXV	
	EX*24(B15,F19)A	24,000	12.05	12.20	-	-	10.7	2242	.74	800	TXV	
	EX*24F19A & EV12F1900A	24,000	13.05	-	-	-	11.9	2017	.75	800	TXV	
	EAH5524SA	24,800	-	-	12.00	-	10.8	2296	.75	800	TXV	
	FCX2400A	24,000	12.05	-	-	-	10.5	2285	.74	800	TXV	
CA9030VKD	EP*30(B15,F19)A	29,200	10.80	11.00	11.30	11.40	10.0	2920	.72	1000	.065	74
	EP*36(B15,F19)A	30,400	11.20	11.30	11.60	-	10.30	2951	.73	1000	.066#	
	EP*36F19A & EV12F1900A	30,200	-	-	13.05	-	11.20	2696	.74	1000	TXV	
	EP*36J22A & EV16J2200A	30,200	-	-	13.05	-	11.20	2696	.74	1000	TXV	
	EX*36F19A & EV12F1900A	30,400	13.50	-	-	-	11.7	2598	.74	1000	TXV	
	EX*36J22A & EV16J2200A	30,400	13.50	-	-	-	11.7	2598	.74	1000	TXV	
	EX*36F19A	30,400	12.40	12.50	-	-	10.8	2814	.73	1000	TXV	
	EX*36(F19,J22)A	30,400	12.40	12.50	-	-	10.8	2814	.73	1000	TXV	
	EAH5536SA	30,400	-	12.00	-	-	10.8	2815	.74	1000	.066	
FCX3600A	30,000	12.40	-	-	-	10.6	2830	.73	1000	TXV		
CA9036VKD	EP*36(B15,F19,J22)A	33,600	11.00	11.20	11.30	-	10.2	3294	.73	1200	.072	76
	EP*36F19A & EV12F1900A	34,000	-	-	12.20	-	10.7	3178	.74	1200	TXV	
	EP*36J22A & EV16J2200A	34,000	-	-	12.20	-	10.7	3178	.74	1200	TXV	
	EP*42(F19,J22)A	35,600	11.50	11.80	12.00	-	10.8	3296	.75	1200	.070#	
	EP*42J22A & EV16J2200A	35,600	-	-	13.05	-	11.8	3051	.76	1200	TXV	
	EP*48(F19,J22,N26)A	36,000	11.60	11.90	12.10	-	10.8	3333	.73	1200	.070#	
	EP*48J22A & EV16J2200A	36,000	-	-	13.10	-	11.8	3051	.74	1200	TXV	
	EX*36(B15,F19,J22)A	35,600	12.05	12.20	-	-	10.7	3327	.73	1200	TXV	
	EX*36F19A & EV12F1900A	35,600	13.00	-	-	-	11.2	3179	.74	1200	TXV	
	EX*36J22A & EV16J2200A	35,600	13.00	-	-	-	11.2	3179	.74	1200	TXV	
	EAH5536SA	35,600	-	12.00	-	-	11.1	3761	.75	1200	.071	
	FCX3600A	35,600	12.05	-	-	-	10.5	3390	.73	1200	TXV	
	CA9042VKD	EP*42(F19,J22)A	39,000	11.30	11.50	-	11.80	10.3	3834	.73	1400	
EP*42J22A & EV16J2200A		40,000	-	-	13.00	-	11.2	3571	.74	1400	TXV	
EP*48F19A		40,000	-	-	-	12.00	10.7	3846	.73	1400	TXV	
EP*48F19A		39,500	11.50	11.80	-	-	10.5	3761	.73	1400	.079#	
EP*48(J22,N26)A		40,500	-	-	12.05	-	10.5	3857	.73	1400	TXV	
EP*48(J22,N26)A		40,000	12.00	11.70	-	-	10.6	3773	.73	1400	TXV	
EP*48J22A & EV16J2200A		42,000	-	-	13.05	-	11.3	2717	.74	1400	TXV	
EP*48N26A & EV20N2600A		42,000	-	-	13.05	-	11.3	2717	.74	1400	TXV	
EX*42(F19,J22)A		41,000	12.05	-	-	-	10.6	3867	.74	1400	TXV	
EX*42J22A & EV16J2200A		41,500	13.05	-	-	-	11.2	3705	.75	1400	TXV	
EAH5548SA		41,500	-	11.10	-	-	11.1	3738	.75	1400	.079#	
FCX4800A		41,000	12.05	-	-	-	10.35	3961	.74	1400	TXV	
CA9048VKD		EP*48F19A	44,000	11.30	-	11.50	-	10.1	4406	.71	1600	.082#
	EP*48(J22,N26)A	45,000	11.30	11.50	11.60	-	10.2	4414	.71	1600	.082#	
	EP*48J22A & EV16J2200A	46,500	-	-	12.4	-	10.7	4346	.72	1600	TXV	
	EP*60(J22,N26)A	46,000	11.50	11.70	12.00	-	10.5	4380	.71	1600	.082#	
	EX*48N26A	46,500	-	-	12.05	-	10.3	4567	.73	1600	TXV	
	EX*48N26A & EV20N2600A	48,500	13.00	-	-	-	11.0	4409	.74	1600	TXV	
	EAH5548SA	47,500	-	-	10.90	-	10.9	4358	.74	1600	TXV	
	FCX4800A	48,500	12.05	-	-	-	10.4	4663	.73	1600	TXV	
CA9060VKD	EP*60J22A	57,000	11.10	11.30	11.50	-	10.3	5534	.69	1800	.090#	76
	EP*60N26A & EV20N2600A	56,500	---	---	12.05	---	10.3	5485	.70	1800	TXV	
	EP*60N26A	58,000	11.10	11.30	11.50	-	10.3	5631	.70	1800	.090	
	EX*60N26A	60,000	12.05	-	-	-	11.0	5454	.69	1800	TXV	
	EX*60N26A & EV20N2600A	58,000	12.30	-	-	-	10.7	5421	.70	1800	TXV	
	EAH5560SA	59,000	-	-	11.00	-	11.0	5363	.72	1800	TXV	
	FCX6000A	57,500	11.60	-	-	-	10.15	5665	.72	1800	TXV	

= Installer Must Change Pin To Size Indicated. Pin shipped with outdoor unit. PIN = Refrigerant Orifice PIN size. TD1 = AMA001TDA Indoor Blower Time Delay Kit, required to make seer indicated. ST9120, FCP, FCX, and EF fan controls also satisfy TD1 requirements. TXV = Thermostatic Expansion Valve, use TXV153 (AMF1531KA) on 1-1/2 to 3 Tons, use TXV355 (AMF3551KA) on 3-1/2 to 5 Tons. For Electric Furnace (EF Series) ratings: EF08B1500A = EPA24B15A + TD1, EF12F1900A = EPA36F19A + TD1, EF16J2200A = EPA48J22A + TD1, EF20N2600A = EPA60N26 + TD1.

EXTENDED REFRIGERANT LINE CORRECTION FACTORS

Varying Line Length in Feet (m) vs. Total Capacity Multiplier					
25 (8)	50 (15)	75 (23)	100 (30)	125 (38)	150 (46)
1.00	.99	.98	.96	.94	.92

REFRIGERANT CHARGE DATA

All models are factory charged with R-22 for outdoor unit, 25' (8m) of refrigerant line and matching indoor section.
 Refrigerant charge correction per foot (305mm) of line:
 1/4" O.D. = .25 oz.; 5/16" O.D. = .45 oz.; 3/8" O.D. = .60 oz.;
 1/2" O.D. = 1.2 oz.

VOLTAGE CORRECTION FACTORS

Volts	Capacity	Watts
208	.98	.99

INDOOR AIRFLOW CORRECTION TABLE

% Rated Air	90	95	100	105	110
Total Cap. Mult.	.98	.99	1.00	1.01	1.03
Sens Cap. Mult.	.95	.98	1.00	1.03	1.05

INDOOR TEMPERATURE CORRECTION TABLE (Based on 95°F Ambient)

Indoor D.B. °F (°C).	Correction Factor	Entering Indoor Wet Bulb °F (°C).						
		59 (15)	61 (16)	63 (17)	65 (18)	67 (19)	69 (20)	71 (21)
70 (21)	Total Cap. Mult.	.90	.93	.96	.99	1.02	-	-
	Sens Cap. Mult.	.86	.85	.82	.77	.70	-	-
75 (24)	Total Cap. Mult.	.89	.92	.95	.98	1.01	1.04	-
	Sens Cap. Mult.	1.04	1.03	1.00	.95	.88	.78	-
80 (26)	Total Cap. Mult.	.88	.91	.94	.97	1.00	1.03	1.06
	Sens Cap. Mult.	1.18	1.17	1.14	1.08	1.00	.89	.73
85 (29)	Total Cap. Mult.	-	.90	.93	.96	.99	1.02	1.05
	Sens Cap. Mult.	-	1.29	1.26	1.20	1.11	.98	.81

Bold Type = approximately 50% Relative Humidity

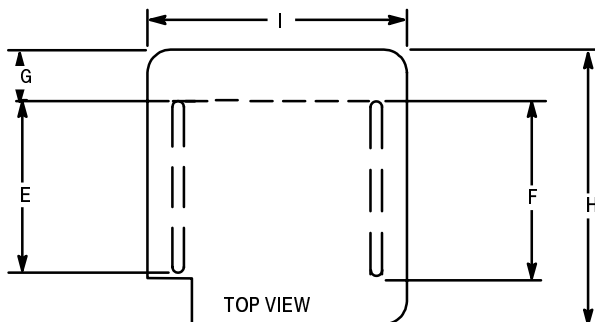
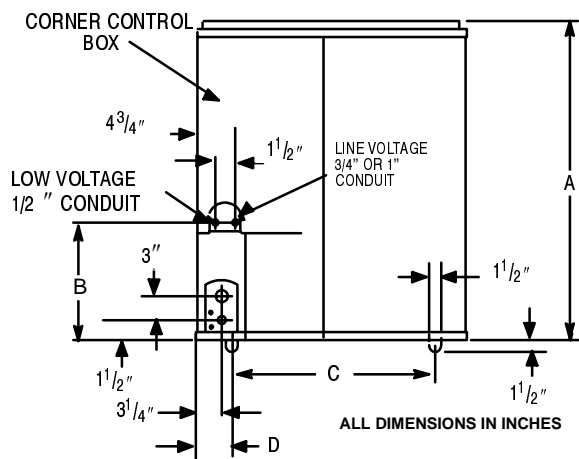

UNIT DIMENSIONS

Model	A	B	C	D	E	F	G	H	I
CA9018VKD	24	10 3/4	17 1/2	4	12 1/2	16 1/2	4 1/2	23 1/2	23 1/2
CA9024VKD	24	10 3/4							
CA9030VKD	26	14 3/4							
CA9036VKD	36	10 3/4	22	4 1/2	17 5/8	18 3/4	5 1/2	30	30
CA9042VKD	30	9 3/4	25 1/2		23 1/2	24 1/2	5 1/2	36	34
CA9048VKD	36	14 3/4							
CA9060VKD	40	14 3/4							

TEMPSTAR®

Heating and Cooling Products

International Comfort Products Corporation (USA)
 651 Heil-Quaker Ave.
 Lewisburg, Tennessee 37091

RESIDENTIAL AND COMMERCIAL SYSTEMS • SPLIT SYSTEMS • PACKAGED AIR CONDITIONERS •
 COMBINATION GAS / ELECTRIC UNITS • HEAT PUMPS • AIR HANDLERS • MANUFACTURED HOME AIR
 CONDITIONERS • GAS, OIL AND ELECTRIC FURNACES